

INSTALLATION INSTRUCTIONS

120-H3 Series



⚠ WARNING

These products may represent a possible shock or fire hazard if improperly installed or attached in any way. Products should be installed in accordance with these instructions, current electrical codes, and/or the current National Electric Code (NEC).

⚠ WARNING

120V Hybrid 3 Reels are cETLus Listed with a max run of 164ft. Safety rating is void if a kit is cut or altered, or if used with any power cord other than the one provided.

⚠ WARNING

To reduce the risk of fire, electric shock or injury to persons, use this flexible light only with American Lighting recommended controllers, power connectors, jumpers and extensions.

⚠ WARNING

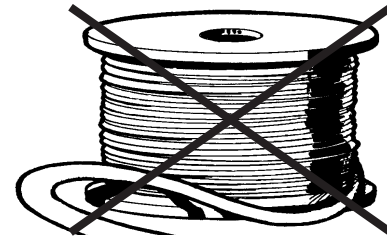

Do not operate Hybrid 3 while it is coiled.

⚠ WARNING

To reduce the risk of fire, electric shock or injury to persons, make sure that the electrical power to the fixture is disconnected at the source prior to installation or any servicing.

SAFETY INFORMATION

- Read all installation instructions before beginning; if not qualified, do not attempt installation. Contact a qualified electrician.
- To reduce the risk of fire, electric shock, or injury to persons, pay close attention to this manual and stay within its guidelines when using this product. Save these instructions for future use.
- Do not cover this product as the covering may cause flexible light to overheat, melt, or ignite.
- Do not operate Hybrid 3 while it is tightly coiled. To prevent overheating, do not allow contact between flexible light cables and parts of light cables. Maintain at least 12mm spacing between flexible light cables or parts of light cables.
- Do not submerge flexible light in liquids, or use the product in the vicinity of standing water or other liquids.
- Do not route the cord or Hybrid 3 through walls, ceilings, doors, windows, or any similar part of the building structure.
- Secure this flexible light using only the mounting clips provided or factory recommended mounting track (sold separately).
- Do not secure this product or its cord with staples, nails, or like means that may damage the insulation.
- Do not use if there is any damage to the PVC housing or power cord insulation. Inspect periodically.
- Do not install on gates or doors, where subject to continuous flexing.
- Do not install within 15 ft of a swimming pool surface. Do not install in tanks or enclosures of any kinds.
- Follow instructions carefully when splicing Hybrid 3 sections or attaching power cords. Ensure that all connections, including the end cap on the last segment, are properly installed with dielectric grease and shrink tube to preclude the entrance of water (outdoor applications). ETL Listing is void when product is cut.
- Risk of fire. Do not replace attachment plug. Discard product if attachment plug is damaged.
- This product has a polarized plug (one blade is wider than the other) as a feature to reduce the risk of electric shock. This plug will fit in a polarized outlet only one way. If the plug does not fit fully in the outlet, reverse the plug. If it still does not fit, contact a qualified electrician. Never use with an extension cord unless plug can be fully inserted. Do not alter plug. This plug contains an electrical fuse as a safety feature. See Page 2 for instructions on replacing the fuse (Use only 8 Amp 125 Volt fuse).
- **120V Hybrid 3 is cETLus Listed, but this safety rating is void if the 164ft reel is cut.** Cutting the Hybrid 3 and/or altering the power cord in any way including, but not limited to cutting, splicing, and/or adding any power accessories will void the cETLus Listing.
- This product is for decorative use only. Not to be used by children as a toy. Keep out of reach of small children.
- Do not exceed 164ft maximum run distance in any single run.

⚠ WARNING

When using outdoor portable lighting products, basic safety precautions should always be followed to reduce the risk of fire, electric shock, and personal injury, including the following:

- Use dielectric grease and shrink tube at all power connections, including end cap when using outdoors.
- Use ground fault circuit interrupter (GFCI) protection on the circuit(s) or outlet(s) when using outdoors.
- Use only UL approved outdoor extension cords, such as type SW, SOW, STW, STOW, SJW, SJOW, SJTW, or SJTOW. This designation is marked on the jacket of the extension cord.

DO NOT TWIST, HANG VERTICALLY, SUSPEND UNSUPPORTED IN THE MIDDLE, OR BEND ALONG SHORT SIDE

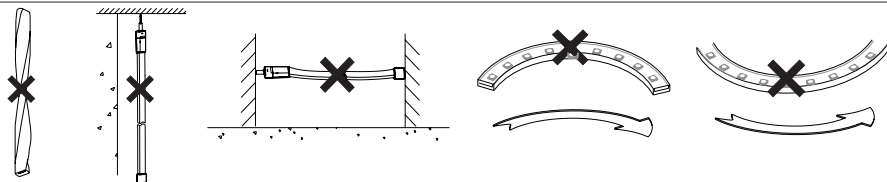

PRODUCT INFORMATION

Hybrid 3 Bulk Reels are sold in 150ft lengths. Each reel includes (1) attached 5ft removable power cord, (4) additional 120-H3-CONKIT, (1) attached removable end cap, and (50) mounting clips with screws. Additional accessories (sold separately) include 120-H3-CONKIT (120V conkit with plug), 120-H3-SPL (splice kit), 120-H3-JUMP.5 (6" linking jumper), 120-H3-JUMP3 (3ft linking jumper), 120-H3-JUMP6 (6ft linking jumper), 120-H3-END (end cap for 120V Hybrid 3) 120-H3-CLIPS (bag of ten plastic mounting clips), 120-H3-CHAN-3 (3.28ft aluminum mounting channel); all sold separately. Power consumption = 4 W/ft; Maximum run = 164 feet

INSTALLATION INSTRUCTIONS

120-H3 Series



CONNECTING POWER CONNECTION KIT OR LINKING WITH JUMPERS (See Figures 1-5):

NOTE: Do not exceed 164ft maximum run distance in any single run. For outdoor use, apply silicone when making power connection and attaching end cap. Secure attached power cord by tightening threaded collar to Hybrid 3 before installing. ETL Listing is void if product is cut.

1. Determine the required length for flexible light.
2. Cut the Hybrid 3 squarely at the nearest cut mark using a sharp rope light cutting tool or shears. See Figure 1. NOTE: Hybrid 3 is wired in parallel with 4" cutting increments. Cutting anywhere other than at a cutting increment will damage an LED and/or internal wiring.
3. Put the rubber ring included with the conkit into the pin block side of the conkit. See Figure 2.
4. Insert the pin block into the Hybrid 3 strip as shown in Figure 3.
5. Press the pin block and Hybrid 3 into the connector's pedestal, then place the cover over the pedestal. See Figure 4.
6. Screw down the lock screws to secure the conkit in place. See Figure 5.
7. Plug the 120V plug into an appropriate 120V socket.

FIGURE 1

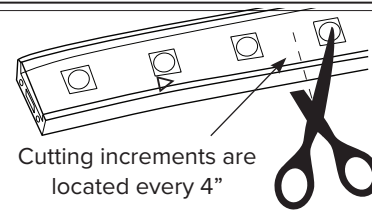

FIGURE 2

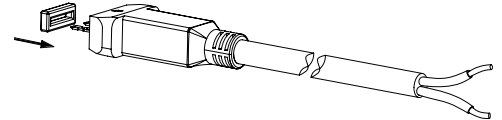

FIGURE 3

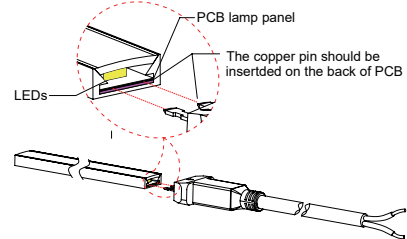

FIGURE 4

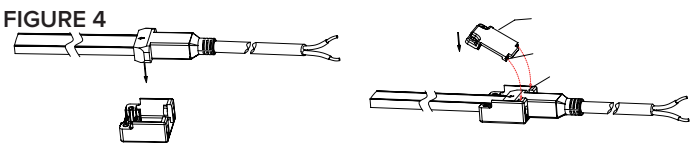
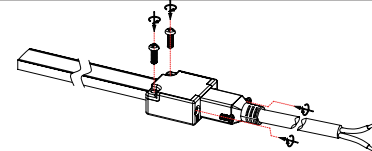

FIGURE 5



LINKING WITH SPLICE KIT (See Figures 6-8):

NOTE: Do not exceed 164ft maximum run distance in any single run. For outdoor use, apply silicone when making power connection and attaching end cap. Secure attached power cord by tightening threaded collar to Hybrid 3 before installing. ETL Listing is void if product is cut.

1. Follow steps 1 and 2 in "Connecting Power" above.
2. Insert the pin block into the Hybrid 3 strip as shown in Figure 6.
3. Press the pin block and Hybrid 3 into the splice kit's pedestal, then place the cover over the pedestal. See Figure 7.
4. Screw down the lock screws to secure the splice kit in place. See Figure 8.

FIGURE 6

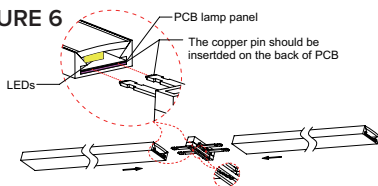

FIGURE 7

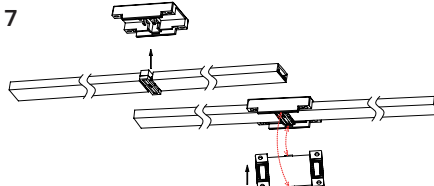
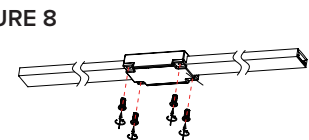

FIGURE 8



MOUNTING WITH MOUNTING CLIPS:

Plastic mounting clips included and sold separately.

1. Attach mounting clips provided using nails or screws. Be sure that the mounting surface is mechanically sound.
2. Mounting clips should be evenly spaced and be a maximum of 12 inches apart.
3. Make sure that the distance between two separate/nearby lines of Hybrid 3 are at least 1/2" apart to ensure heat distribution.

MOUNTING WITH CHANNEL:

120-H3-CHAN-3 sold separately

1. Using appropriate fasteners, attach mounting track/channel to a mechanically sound surface.
2. Gently press Hybrid 2 Kit onto track/channel so that it snaps into place and the Hybrid 3 does not move.

TO REPLACE FUSE:

This plug contains an electrical fuse as a safety feature.

1. Disconnect power before replacing the fuse.
2. Grasp plug and remove from the receptacle or other outlet device.
3. Do not unplug by pulling on the cord.
4. Slide open the fuse access cover (See figure 4).
5. Remove old fuse carefully.
6. Never attempt to replace the fuse with a higher wattage fuse. Use only 8Amp 125Volt fuse. Failure to do so may be a fire hazard. (One spare fuse is included; stored inside plug for convenience)
7. Set new fuse in holder and close fuse access cover.

FIGURE 4

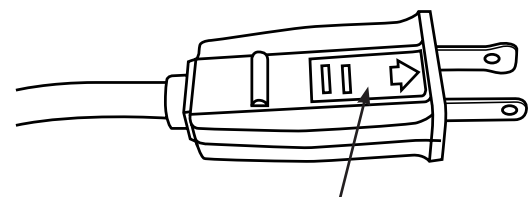

Fuse is inside plug.
Slide open fuse access cover as shown.

CARE AND MAINTENANCE:

1. For cleaning, use a soft, dry or damp cloth. Do not use harsh chemicals or abrasives.